

OUTLET	NO. BARS	BAR SIZE
6"	1	3/8" X 1-1/2"
8"	1	3/8" X 1-1/2"
10"	2	3/8" X 2"
12"	2	3/8" X 2"
14"	2	3/8" X 2"
16"	3	3/8" X 2"
18"	3	3/8" X 2"
20"	4	3/8" X 2"
24"	4	3/8" X 2"
30"	5	3/8" X 2"
36"	5	3/8" X 2"
42"	6	1/2" X 2"
48"	6	1/2" X 2"

This is a Precision Flange & Machine Standard scraper bar configuration. Other configurations are available to suit customer specifications.

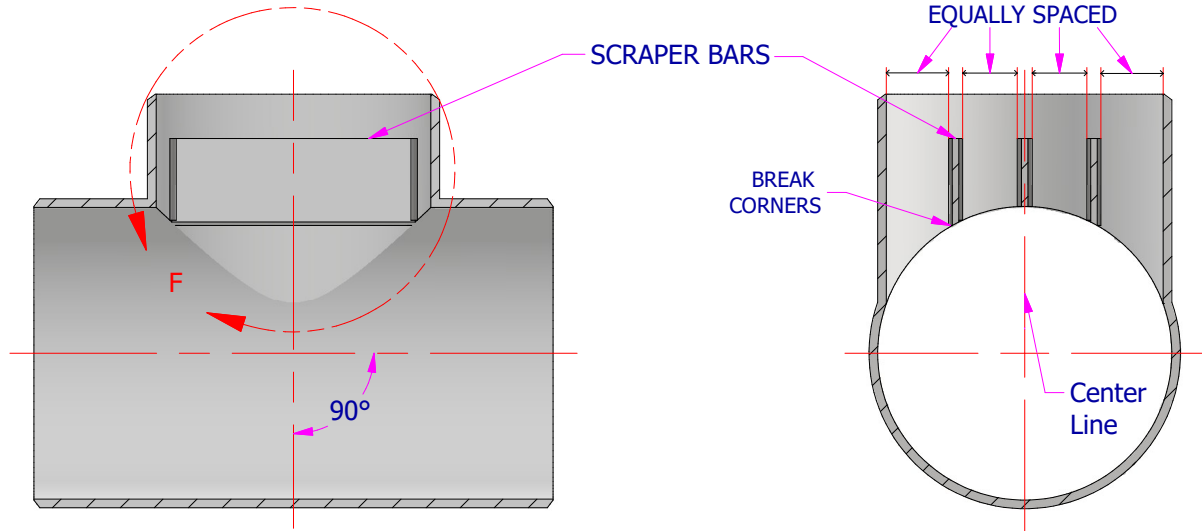

NOTES :

- All guide bars are to appear visually equally spaced in branch.
- All guide bars to have rounded edges on bottom only.
- When an odd number of guide bars is specified, they shall be spaced with one bar on the center line of the outlet.
- When an even number of guide bars is specified, they shall be spaced to straddle the center line of the outlet.
- All tees must have one bar heat each.
- Stamp material grade and heat # on at least one bar.
*Tee manufacturer's marking will not be altered unless illegible from processing.
- All bars to be one piece.
- Quenched and tempered material to be stress relieved at 50 F or more below the tempering temperature.
- For scraper bar tees material grade WPHY-52 and higher shall be inspected after final heat treatment using dye penetrant or magnetic particle method per ASTM E165 or ASTM E709 respectively.

Tee Grade	Plate Grade
WPB	A516-70/65/60N
WPL6	A516-70/65/60N
HY<WPHY52	A516-70/65/60N
WPHY52	A537 CL1, A633-C
WPHY60	A537 CL1, A633-C

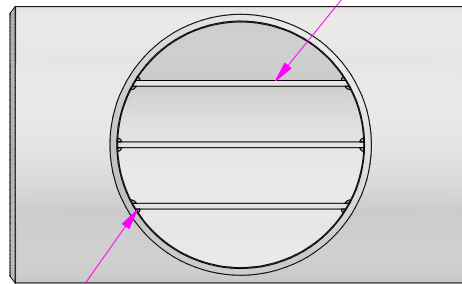

TYP. $\frac{3}{8}$ " $\frac{3}{8}$ "

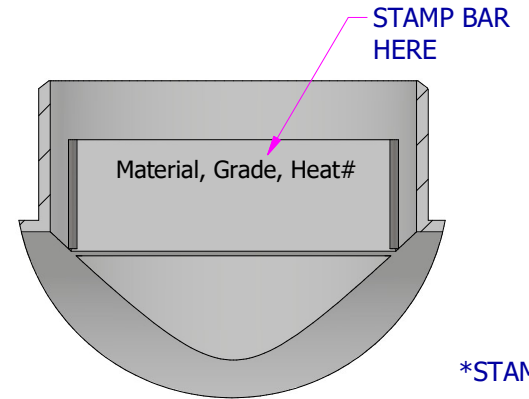

DETAIL F

***STAMP:**

**SIZE
MATERIAL
HT #
PFAM**

DRAWN BY Roger S	DATE 10.21.2025
APPROVED BY <i>S.B.</i>	DATE 10/21/2025
DESCRIPTION SCRAPER BARS	
DRAWING NUMBER SCRAPER BARS	REV 4

